

Dial Calipers

Rugged construction - High accuracy - Patented shockproof design - Ideal for use in the workshop.

Brown & Sharpe DIAL-CAL® Dial Calipers - Inch

Stainless Steel Construction - Adjustable Zero Set - 1.25" Diameter Rotating Dial with Lock - Anti-backlash - Shockproof Design.

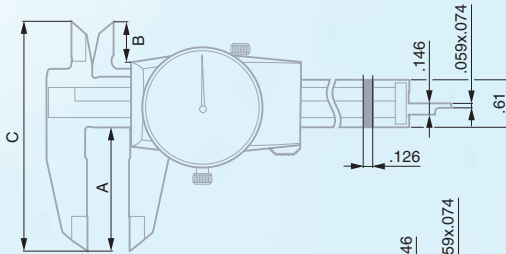
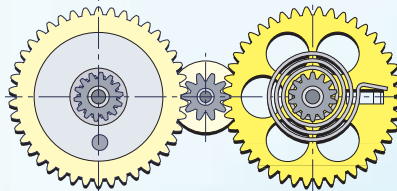

599-579-4
599-579-5

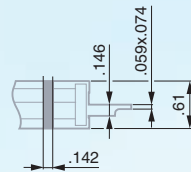

599-579-8-1

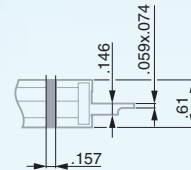

599-579-12-1



- DIN 862 (Style 1AR)
- .001 in / 100 mm; 20 μm >.001 in / 100 mm: 30 μm
- Hardened stainless steel
- 1.25 in diameter rotating dial with lock
- Slider with locking screw
- Steel gear mechanism, hardened and ground
- Patented shockproof design
- Suited plastic case
- Identification number
- Inspection report with a declaration of conformity

						Wheel Drive	Face Color		A	B	C	Depth Bar
599-579-4	51774	0 - 6 in	.001 in	.100 in	without	Silver		1.5 in	.512 in	2.91 in	Provided	
599-579-5	51879	0 - 6 in	.001 in	.100 in	without	Black		1.5 in	.512 in	2.91 in	Provided	
599-579-8-1	27594	0 - 8 in	.001 in	.100 in	with	Silver		1.9 in	.811 in	3.52 in	Provided	
599-579-8-5-1	27593	0 - 8 in	.001 in	.100 in	with	Black		1.9 in	.811 in	3.52 in	Provided	
599-579-12-1	27592	0 - 12 in	.001 in	.100 in	with	Silver		2.5 in	.860 in	4.15 in	Provided	
599-579-12-5-1	27591	0 - 12 in	.001 in	.100 in	with	Black		2.5 in	.860 in	4.15 in	Provided	
599-579-14	51775	0 - 150 mm	.02 mm	2 mm	with	Yellow		40 mm	13 mm	74 mm	Provided	
Optional Accessory												
05.60013	42534	Depth measuring foot for models with a 6 in / 150 mm measuring span.										