

MarCator 1086 R

► | The new Digital Indicator **MarCator** 1086 R. With the large display and the integrated tolerance function, your measurement results are clearly visual. | ◀

Clear display

Tolerance indication with the displayed value

Displayed is the actual measured value and the tolerance zone position

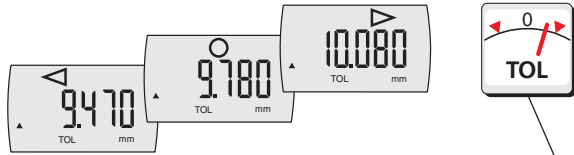

Tolerance indication without the value in the display. In and Out of tolerance will be indicated in the display as a symbol.

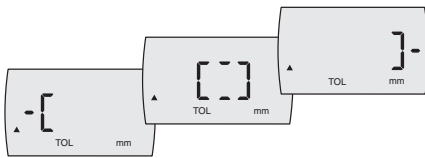

IP Protection class IP54 (optional)

- Protection cap is sealed
- Rubber bellows for the measuring spindle
- Sealed battery compartment

Code Initial	IP	International Protection
First Numeral	5	Dust protected
Second Numeral	4	Protection against splash water in all directions



Error free operation



Lock function: This prevents unintentional activation of an operating button. Either all the operating buttons or only certain individual buttons can be locked. If a locked operating button is pressed the "LOC" symbol will appear in the display.

Universal Data-Interface



- **USB**
No interface box is required! Simple and inexpensive way to set up a multiple measuring instruments via a USB hub



- **Digimatic**
To connect a Digimatic compatible evaluation instrument



- **Mahr Opto RS232C**
For direct connection to a COM port on a PC



Absolute function:

Digital Indicator can be set in any position to 0.000 without losing the reference to the preset value.

Battery service life is 3 years

The new Reference system is extremely energy efficient as when the caliper is in standby mode; almost no power is required, thus **extending the life of the battery up to 3 years.**

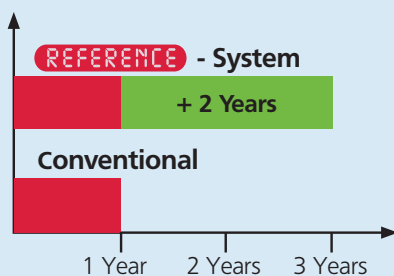

Just set once to zero

REFERENCE The new Digital Indicators 1086 R are equipped with the innovative Reference-System. The zero position only has to be set one time: once it is set, the zero remains stored for all further measurements. Therefore, when the indicator is switched ON or the measuring spindle is moved the indicator is immediately ready for measurement; thus the need to reset as with a conventional indicator is now obsolete.

Digital Indicators MarCator 1086 R / 1086 ZR, Resolution 0.01 mm / .0005"



REFERENCE



12.5 mm



25 mm



50 mm

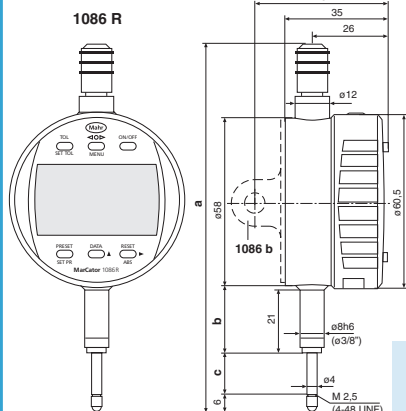

Dimensions

Measuring range		a	b	c
mm	(inch)	mm	mm	mm
12.5	(.5")	126.3	23	13.5
25	(1")	153.4	26.8	26.5
50	(2")	267.3	40	52
100	(4")	420.3	91	103

Features

Functions:

- ON/OFF
- RESET (Set display to zero)
- mm/inch
- Reversal of the counting direction
- PRESET (Allows the entry of any value using set buttons)
- TOL (Enter tolerance limit values)
- ABS (Display can be set to zero, without losing the reference to the Preset value)
- <0> (Tolerance GO / NO GO display mode)
- DATA (when connected with a data connection cable)
- Factor (adjustable)
- Immediate measurement due to the Reference system
- Individual buttons can be locked - Lock Function
- Operating and display unit (bezel) can be rotated 280°
- High contrast LCD with 11 mm high digits
- Inductive measuring system, battery life ca. 2000 hrs.
- Maximum measuring speed 1.5 m/s (60"/s)
- Lifter protection cap on the measuring spindle
- MarConnect data output: choose either USB, OPTO RS232C, Digimatic
- Operating temperature 10 - 40°C
- Class of protection IP42 in accordance to IEC 60529

Supplied with:
Battery, operating instructions

Technical Data

Measuring range		Resolution	Span of error*	Repeatability	Measuring force	Weight	Mounting shank	Order no.
mm	(inch)	mm / inch	mm	mm	N	g	dia.	
12.5	(.5")	0.01 / .0005"	0.02	0.01	0.65 - 0.90	130	8h6	4337130
25	(1")	0.01 / .0005"	0.02	0.01	0.65 - 1.15	140	8h6	4337131
50	(2")	0.01 / .0005"	0.02	0.01	1.25 - 2.70	190	8h6	4337132
100	(4")	0.01 / .0005"	0.02	0.01	1.60 - 3.50	235	8h6	4337133
12.5	(.5")	0.01 / .0005"	0.02	0.01	0.65 - 0.90	150	3/8"	4337155
25	(1")	0.01 / .0005"	0.02	0.01	0.65 - 1.15	160	3/8"	4337156

* in any zero point

Digital Indicators MarCator 1086 R / 1086 ZR, Resolution 0.001 mm / .00005"



REFERENCE



12.5 mm



25 mm



50 mm

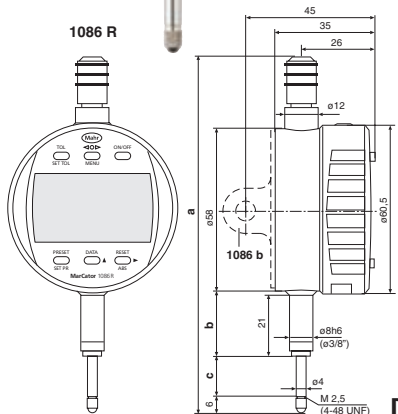

Dimensions

Measuring range		a	b	c
mm	(inch)	mm	mm	mm
12.5	(.5")	126.3	23	13.5
25	(1")	153.4	26.8	26.5
50	(2")	267.3	40	52
100	(4")	420.3	91	103

Features

Functions:

- ON/OFF
- RESET (Set display to zero)
- mm/inch
- Reversal of the counting direction
- PRESET (Allows the entry of any value using set buttons)
- TOL (Enter tolerance limit values)
- ABS (Display can be set to zero, without losing the reference to the Preset value)
- <0> (Tolerance GO / NO GO display mode)
- DATA (when connected with a data connection cable)
- Factor (adjustable)
- Immediate measurement due to the Reference system
- Individual buttons can be locked - Lock Function
- Operating and display unit (bezel) can be rotated 280°
- High contrast LCD with 11 mm high digits
- Inductive measuring system, battery life ca. 2000 hrs.
- Maximum measuring speed 1.5 m/s (60"/s)
- Lifter protection cap on the measuring spindle
- MarConnect data output: choose either USB, OPTO RS232C, Digimatic
- Operating temperature 10 - 40°C
- Class of protection IP42 in accordance to IEC 60529

Supplied with:
Battery, operating instructions

Technical Data

Measuring range		Resolution	Span of error*	Repeatability	Measuring force	Weight	Mounting shank	Order no.
mm	(inch)	mm / inch	mm	mm	N	g	dia.	
12.5	(.5")	0.001 / .00005"	0.005	0.002	0.65 - 0.90	130	8h6	4337120
25	(1")	0.001 / .00005"	0.005	0.002	0.65 - 1.15	140	8h6	4337121
50	(2")	0.001 / .00005"	0.008	0.002	1.25 - 2.70	190	8h6	4337122
100	(4")	0.001 / .00005"	0.009	0.002	1.60 - 3.50	235	8h6	4337123
12.5	(.5")	0.001 / .00005"	0.005	0.002	0.65 - 0.90	150	3/8"	4337150
25	(1")	0.001 / .00005"	0.005	0.002	0.65 - 1.15	160	3/8"	4337151

* in any zero point

Digital Indicators MarCator 1086 WR, Waterproof version



REFERENCE



12.5 mm



25 mm

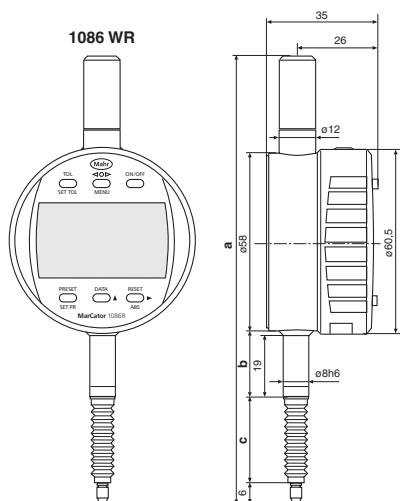

Dimensions

Measuring range		a	b	c
mm	(inch)	mm	mm	mm
12.5	(.5")	144.3	23	28.6
25	(1")	193.2	26.8	50

Features

Functions:

- ON/OFF
- RESET (Set display to zero)
- mm/inch
- Reversal of the counting direction
- PRESET (Allows the entry of any value using set buttons)
- TOL (Enter tolerance limit values)
- ABS (Display can be set to zero, without losing the reference to the Preset value)
- <0> (Tolerance GO / NO GO display mode)
- DATA (when connected with a data connection cable)
- Factor (adjustable)
- Immediate measurement due to the Reference system
- Individual buttons can be locked - Lock Function
- Operating and display unit (bezel) can be rotated 280°
- High contrast LCD with 11 mm high digits
- Inductive measuring system, battery life ca. 2000 hrs.
- Maximum measuring speed 1.5 m/s (60"/s)
- Sealed protection cap
- Measuring spindle is sealed with a rubber bellows, thus preventing contamination by liquids and impurities
- MarConnect data output: choose either
USB
OPTO RS232C
Digimatic
- Operating temperature 10 - 40°C
- Class of protection IP54 in accordance to IEC 60529

Supplied with:
Battery, operating instructions

Technical Data

Measuring range	Resolution	Span of error*	Repeatability	Measuring force	Weight	Order no.
12.5	0.001 / .00005"	0.005	0.002	0.65 - 1.40	135	4337140
25	0.001 / .00005"	0.005	0.002	1.00 - 2.25	145	4337141
12.5	0.01 / .0005"	0.02	0.01	0.65 - 1.40	135	4337145
25	0.01 / .0005"	0.02	0.01	1.00 - 2.25	145	4337146

* in any zero point

Accessories for MarCator 1086 R, 1087 R and 1088

Accessories for MarCator 1086 R and 1087 R

	Order no.
Battery 3V , Type CR 2450	4884464
Data Connection Cable USB (2 m)	16 EXu 4102357
Data Connection Cable Opto RS232C (2 m), with SUB-D jack 9-pin	16 EXr 4102410
Data Connection Cable Digimatic (2 m). Flat plug 10-pin	16 EXd 4102411
Mounting Lug	1086 b 4337421
Rubber bellows for 1086 W - 12.5 mm	4337472
Rubber bellows for 1086 W - 25 mm	4337474

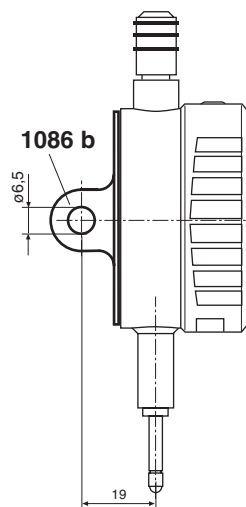

Accessories for MarCator 1088

	Order no.
Data Connection Cable USB (2 m)	2000 usb 4346023
Data Connection Cable Opto RS232C (2 m), with SUB-D jack 9-pin	2000 r 4346020
Data Connection Cable Digimatic (2 m). Flat plug 10-pin	2000 d 4346021
Cable to connect control output to an SPS	2000 sps 4346031
Mounting Lug	1085 b 4336310
Rubber bellows for 1088 W - 12.5 mm	4337472
Rubber bellows for 1088 W - 25 mm	4337474
Control Instrument for remote control operation	2000 sg 4346035

1085 a

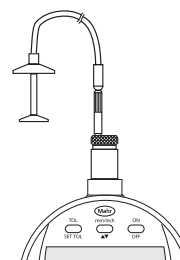

Accessories for MarCator 1086 R, 1087 R and 1088

	Order no.
Cable Release for measuring ranges 12.5 and 25 mm	1085 a 4336311
Pneumatic Lifter for measuring ranges 12.5 and 25 mm	1082 p 4336237
Pneumatic Lifter for measuring ranges 50 and 100 mm	1082 p 4336230
Additional Accessories	Page
Contact Points	901-913 5-52
Special Holder	941 5-53
Sensor Lever	943 5-53

1082 p (12.5/25)

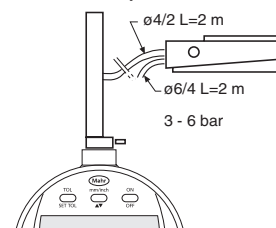

1082 p (50/100)

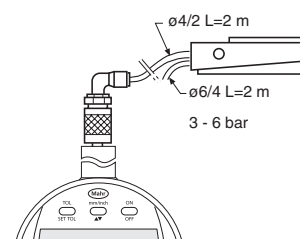

Accessories for Data Processing see Chapter 11

Contact Points and Accessories for Dial Indicators, Dial Comparators and Probes

Standard Contact Points 901

Ball dia. 3 mm

Catalog no.		Order no.
901	with steel ball	4360001
901 H	with carbide ball	4360002
901 R	with ruby ball	4360003

Spherical Contact Points 902 Flat Contact Points 903

902	902 H	903	903 H
Steel	Carbide contact face	Steel	Carbide tipped
Length mm	Order no.	Order no.	Order no.
4	4360007	—	4360070
6	4360009	—	4360071
8	4360010	4360040	4360072
10	4360011	4360041	4360073
12	4360012	4360042	4360074
15	4360013	4360043	4360075
20	4360014	4360044	4360076
25	4360015	4360045	4360077
30	4360016	4360046	4360300
35	4360017	4360047	4360078
40	4360019	4360049	4360310
45	4360026	4360050	4360303
50	4360018	4360048	4360079
55	4360031		
65	4360035		
75	4360020		
85	4360036		
95	4360029		

Ball Contact Point 906 H

with carbide ball, accuracy ball dia. 0/-6µm

Ball dia. d mm	l mm	Order no.	Ball dia. d mm	l mm	Order no.
1	8.5	4360150	5.5	9	4360161
1.25	8.5	4360151	6	9	4360162
1.5	8.5	4360152	6.35 (1/4")	9	4360163
1.75	8.5	4360153	6.5	10	4360164
2	8.5	4360154	7	10	4360165
2.5	8.5	4360155	7.5	11	4360166
3	8.5	4360156	8	11	4360167
3.5	8.5	4360157	8.5	12	4360168
4	8.5	4360158	9	12	4360169
4.5	8.5	4360159	10	13	4360170
5	9	4360160			

Contact Rollers 909

Concentricity error 3 µm

	Order no.
Cylindrical Roller	909 A 4360220
Radiused Roller, R = 5 mm	909 B 4360221

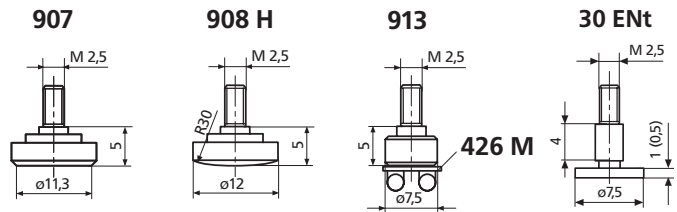
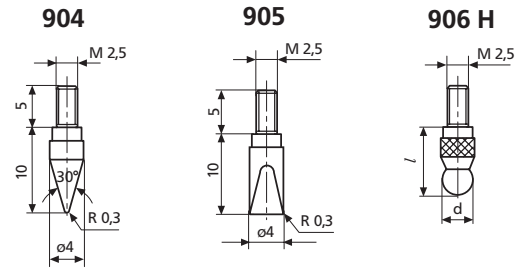
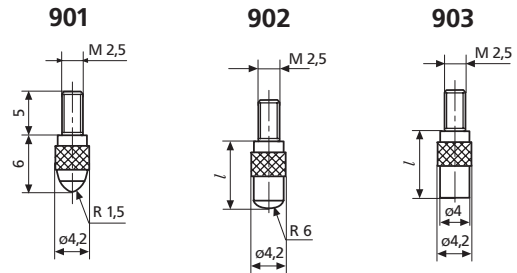

Special Contact Points

	Order no.
Conical Contact Points, Steel	904 4360130
Carbide tipped	904 H 4360131
Wedge Shaped Contact Points, Steel	905 4360140
Carbide tipped	905 H 4360141
Flat Contact Points, Steel, A = 1 cm²	907 4360200
Carbide tipped, dia. 7 mm	907 H 4360201
Spherical Contact Points, Steel	908 4360210
Carbide tipped	908 H 4360211
Flat Contact Point, for mounting	
Pin Gage Holder 426 M for measuring threads using three-wire method	913 4360400
Disc Type anvil thickness 0.5 mm, hardened	30 ENT 4126310
Disc Type anvil thickness 1 mm, hardened	30 ENT 4882022

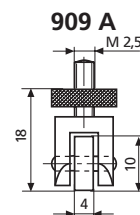

Contact Points and Accessories for Dial Indicators, Dial Comparators and Probes

Measuring Attachment 910 H

	Order no.
with parallel adjustable carbide blades	910 H 4360230

Pin Contact Point 911

dia. 1.5 mm, flat

Length <i>l</i> mm	Order no.	Length <i>l</i> mm	Order no.
15	4360280	35	4360284
20	4360281	40	4360285
25	4360282	50	4360286
30	4360283		

Pin Contact Point 911 H

	Order no.
Carbide tipped, dia 1 mm, flat	911 H1 4360240
Carbide tipped, dia 1.5 mm, flat	911 H2 4360241

Measuring Spindle Extensions 912

Length <i>l</i> mm	Order no.	Length <i>l</i> mm	Order no.
10	4360250	35	4360254
15	4360251	50	4360255
20	4360252	75	4360256
25	4360253	100	4360257

Special Holder 941

For all types of measuring equipment
 For placing a dial indicator at a certain distance or angle
 Travel of the measuring spindle 3 mm
 Contact Point 901 (interchangeable)

Straight Holder 941 G
 Mounting shank length *l*₁

Angular Holder 941 W

Order no.	<i>l</i> ₂	Order no.	<i>l</i> ₂	Order no.	<i>l</i> ₂
25	4365000	53.7	35	49.3	34.5
50	4365001		50		
75	4365002		75		

Sensor Level 943

	Order no.
For testing concentricity in bore holes as well as difficult to reach outside diameters To be inserted in a measuring stand with a lifting device Contact Point 901 interchangeable Travel ±1 mm	4367000

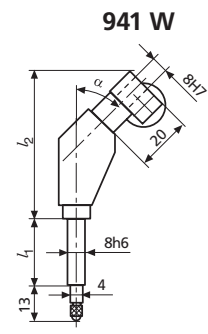
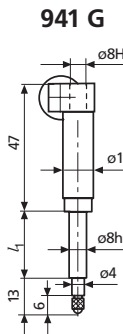
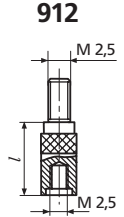
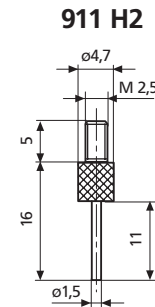
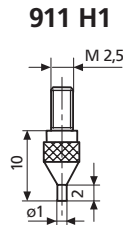
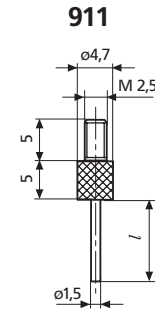
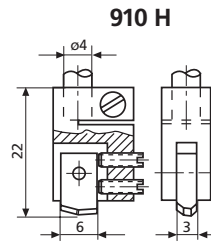

Transmission error with the 941 W
 max. 1%;
 for travel 3 mm = 0.03 mm

