

Series 148

Ultra-small size

Range: 5mm/.2"
 Graduation: 0.02mm/.001"
 Accuracy: ±0.005mm
 Spindle face: SKS3(material)
 More than HRC60
 Lapped surface
 Scale surface: Hard-Chrome plating

Unit: mm

ø6mm thimble and 4g weight, ultra-small size micrometer head for limited space applications.

Order No. (metric)

		Spherical face	Rev. reading
Plain stem	—	148-215	—
With clamp nut	—	148-216	—

Order No. (inch)

		Spherical face	Rev. reading
Plain stem	—	148-217	—
With clamp nut	—	148-218	—



Plain stem

Spherical face
 148-215, 148-217

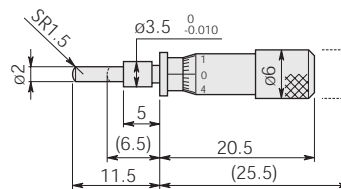

Mass (g): 4

Stem with clamp nut

Fixture thickness: 3mm

Spherical face
 148-216, 148-218

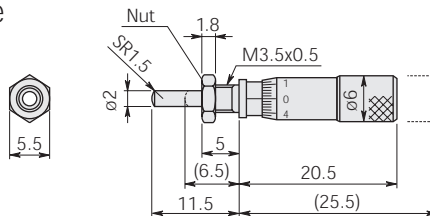

Mass (g): 4

Series 148

Small size

Range: 6.5mm/.25"
 Graduation: 0.01mm/.001"
 Accuracy: ±0.005mm
 Spindle face: SKS3(material)
 More than HRC60
 Lapped surface
 Scale surface: Hard-Chrome plating

Unit: mm

37mm length small size micrometer head. It does not require large installation space.

Order No. (metric)

		Spherical face	Rev. reading
Plain stem	148-201	148-205	148-209
With clamp nut	148-203	148-207	148-211

Order No. (inch)

		Spherical face	Rev. reading
Plain stem	148-202	148-206	148-210
With clamp nut	148-204	148-208	148-212

Plain stem

148-201, 148-202

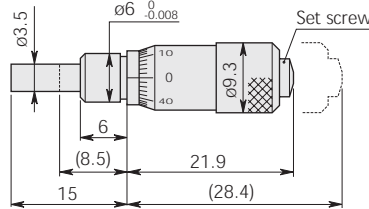

Mass (g): 10

Spherical face

148-205, 148-206

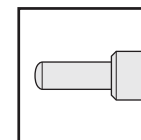

Reverse reading

148-209, 148-210

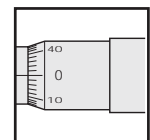

Stem with clamp nut

Fixture thickness: 4mm

148-203, 148-204

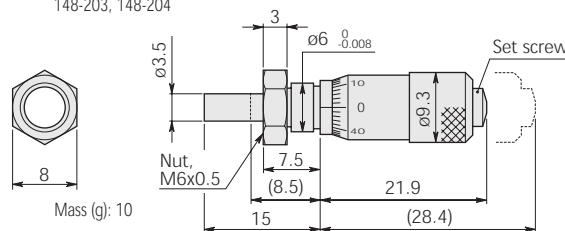

Mass (g): 10

Spherical face

148-207, 148-208

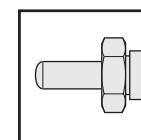

Reverse reading

148-211, 148-212

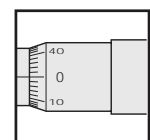

(): When retracting the spindle until its stroke end.